





Showground, Hoburne Blue Anchor, Minehead, Somerset.

Directions

Please use the postcode TA24 6JT or call the office at any time for detailed directions from your location.

The Important bits

2014 ABI Summerbreeze 36 x 12 - *WITH FREE SITE FEES FOR 2026*

Licence until November 2029

Summary

This stunning 2-Bedroom holiday home is available to purchase now for an unbelievably low price situated at Hoburne Blue Anchor directly on Blue Anchor Bay. The home itself will give you everything you need to start your holiday home journey, plus, there will be no site fees to pay until 1st December 2026. What more could you ask for?!

Step inside

The property is accessed into the kitchen area which benefits from a range of storage and appliances. It is open to the large living area which has separate sitting and dining areas with fitted furniture including a sofa bed. A hallway provides access to the two bedrooms and shower room which is fitted with a suite comprising shower cubicle, wc, and wash hand basin. Both bedrooms come with bedroom furniture which includes built in storage and the master bedroom also has an ensuite toilet with airing cupboard.

Step outside

As this property is currently located on the showground at Hoburne Blue Anchor, new owners will have the luxury of selecting their desired position on park based on current availability. Once confirmed, the Hoburne maintenance team

will work hard and efficiently to have it sited, connected, and ready for use within as little as 14 days.

Area insight

The park has a warm, welcoming vibe, with regular monthly events just for owners. Blue Anchor is proud to be a genuinely pet-friendly location, surrounded by plenty of scenic walks right on your doorstep. Running alongside the holiday park is Blue Anchor Beach which is open to dogs all year, and a favourite spot for fishing enthusiasts. Much of the park faces south, meaning long days of sunshine and lovely views of the West Somerset Railway. Watching the steam trains chug by is endlessly charming. As an owner at Hoburne Blue Anchor, one of West Somerset's hidden gems, you will have access to a coffee shop/farm shop, fitness suite, sauna, steam room, children's play area, and a heated indoor pool, along with an exciting programme of exclusive events throughout the year.

Viewing

Viewing is available by appointment 7 days a week. Please call your local office to arrange.

Agents Note

We wish to inform prospective purchasers that we have prepared these sales particulars as a general guide. We have not carried out a survey, nor have we tested any services, appliances or any specific fittings at the property. Room sizes should not be relied upon for carpets and furnishings.

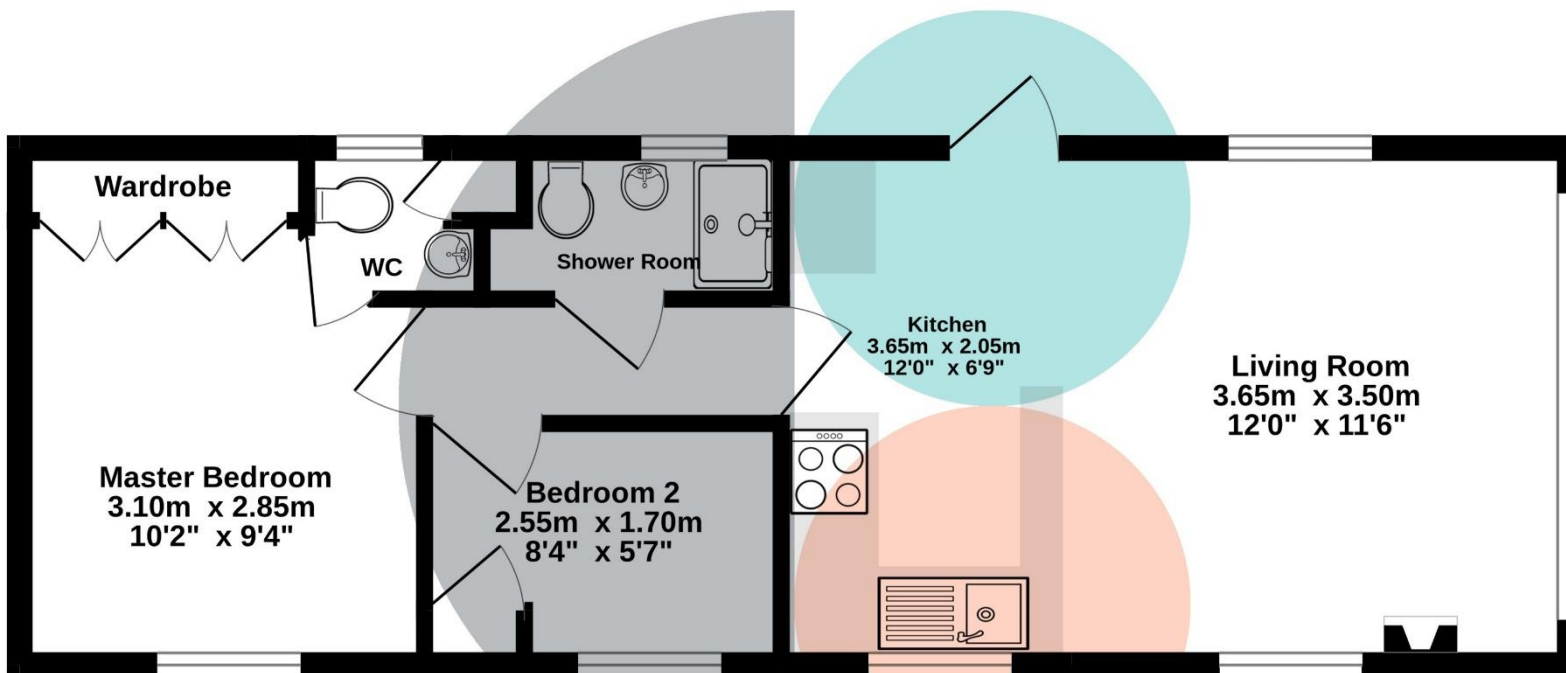

Whilst every attempt has been made to ensure the accuracy of the floorplan contained here, measurements of doors, windows, rooms and any other items are approximate and no responsibility is taken for any error, omission or mis-statement. This plan is for illustrative purposes only and should be used as such by any prospective purchaser. The services, systems and appliances shown have not been tested and no guarantee as to their operability or efficiency can be given.
Made with Metropix ©2025

